



Duarte Civic Center
23 January 2024



PHASE - I

Exterior Improvements
to Civic Center Buildings

PHASE I (Exterior Improvements) : Material Selection Criteria



- Low Maintenance
- Durability
- Aesthetics
- Materials
 - Aluminum composite material (ACM) - comes in a broad palette of colors and finishes.
 - Parklex Prodema - Laminated wood board that ensure optimum performance on exteriors.
 - Equitone - Fiber cement facades are high-density, high-performance facade panels
 - Trespa - Compressed impregnated paper or wood fibers and epoxy, phenolic or polypropylene resin at high pressure and high temperature.

PHASE I (Exterior Improvements) : Parklex Prodema

Laminated wood board for exteriors that combine the virtues of wood with technical requirements to ensure optimum performance on exteriors over time.

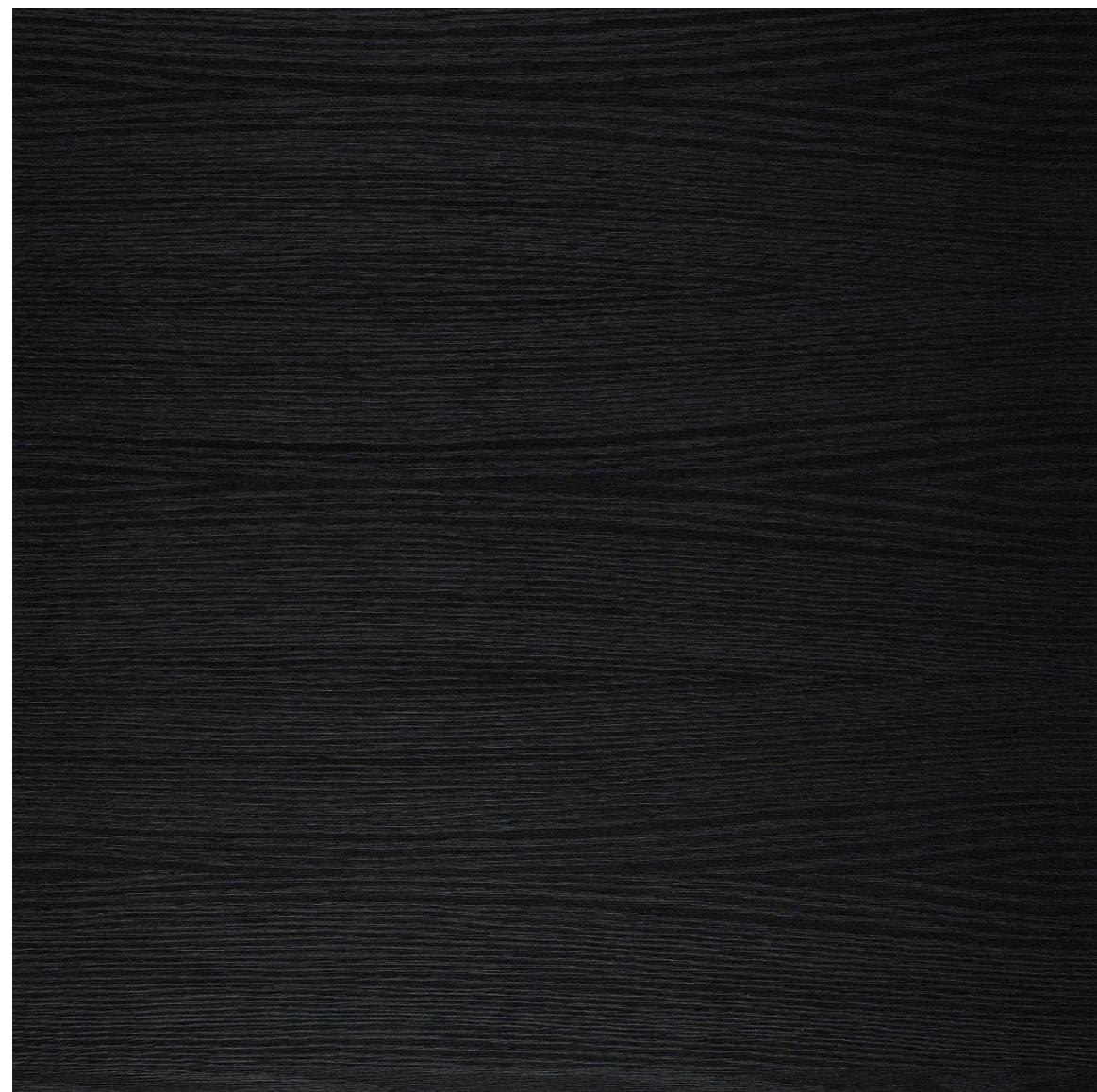

PHASE I (Exterior Improvements) : Trespa

Made by compressing impregnated paper or wood fibers and epoxy, phenolic or polypropylene resin at high pressure and high temperature.

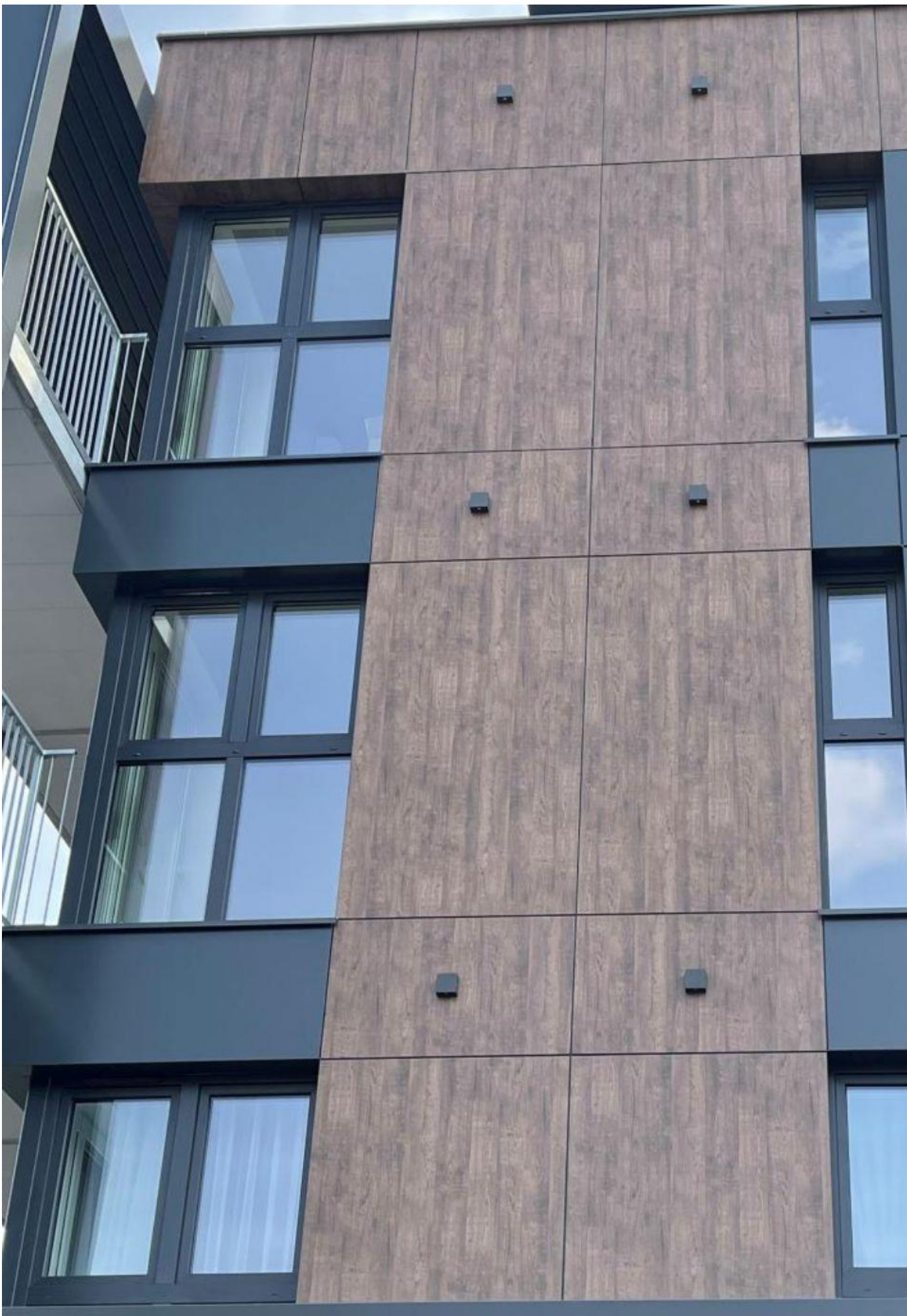

PHASE I (Exterior Improvements) : View Towards City Hall Entry



PHASE I (Exterior Improvements) : View Towards Council Chambers Entry



PHASE I (Exterior Improvements) : View Towards Water Feature



PHASE I (Exterior Improvements) : View From Street







PHASE - II

City Hall Interior

PHASE II (City Hall Interior) : Floor Plan

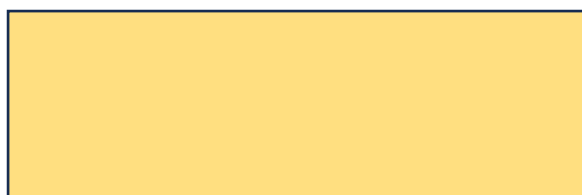

-  Community Development
-  Parks & Recreation
-  Administrative Services
-  City Manager's Office
-  Support Spaces

PHASE II (City Hall Interior) : View From Community Development



PHASE II (City Hall Interior) : View Towards Graphic Wall





PHASE - III

Community Center Renovation

PHASE III (Community Center Renovation) : Floor Plan

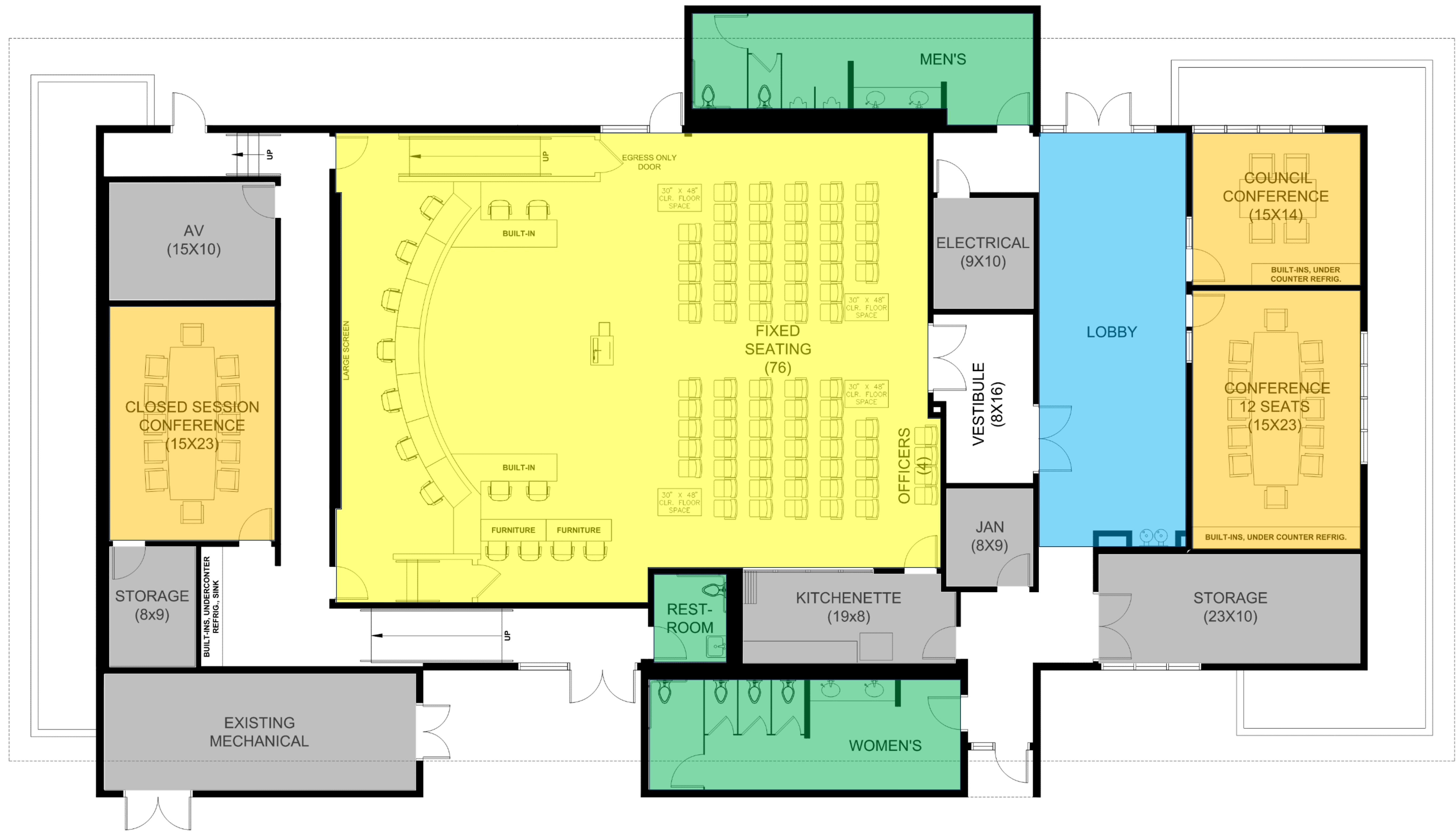

- Council Chambers
- Restrooms
- Lobby
- Conference Rooms
- Support Spaces

PHASE III (Community Center Renovation) : Workshop Layouts

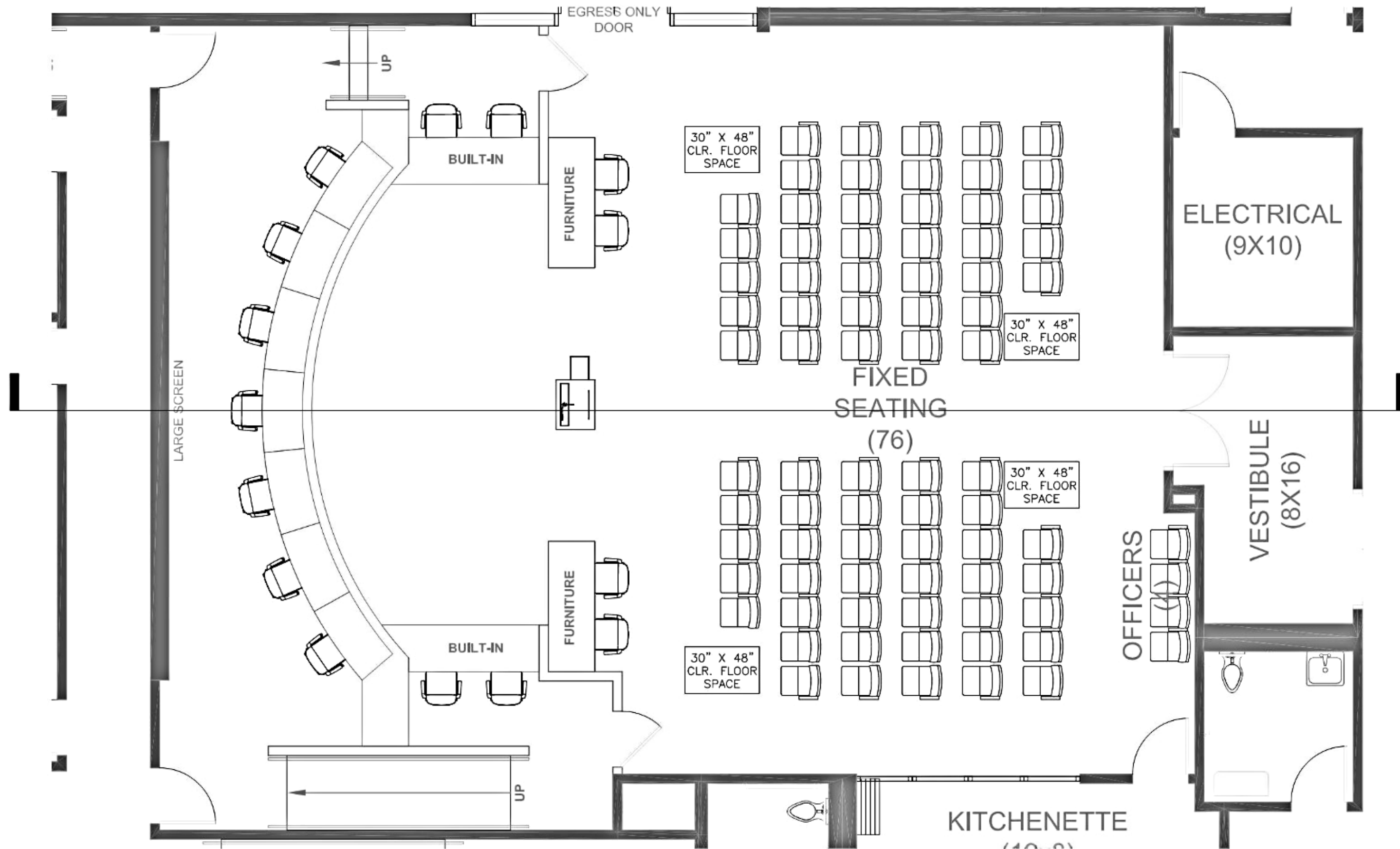

TYPICAL COUNCIL MEETING LAYOUT

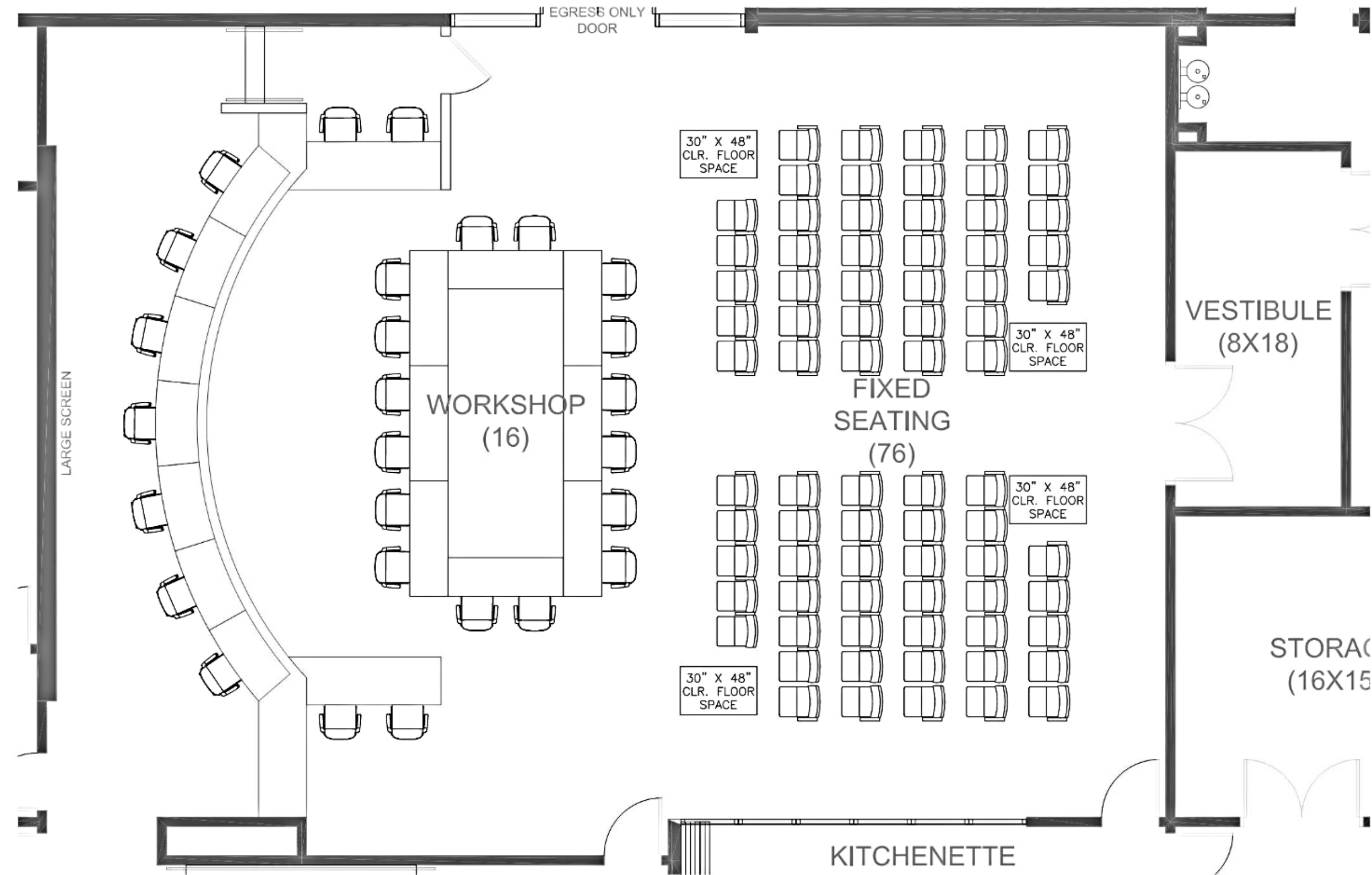

SAMPLE WORKSHOP LAYOUT

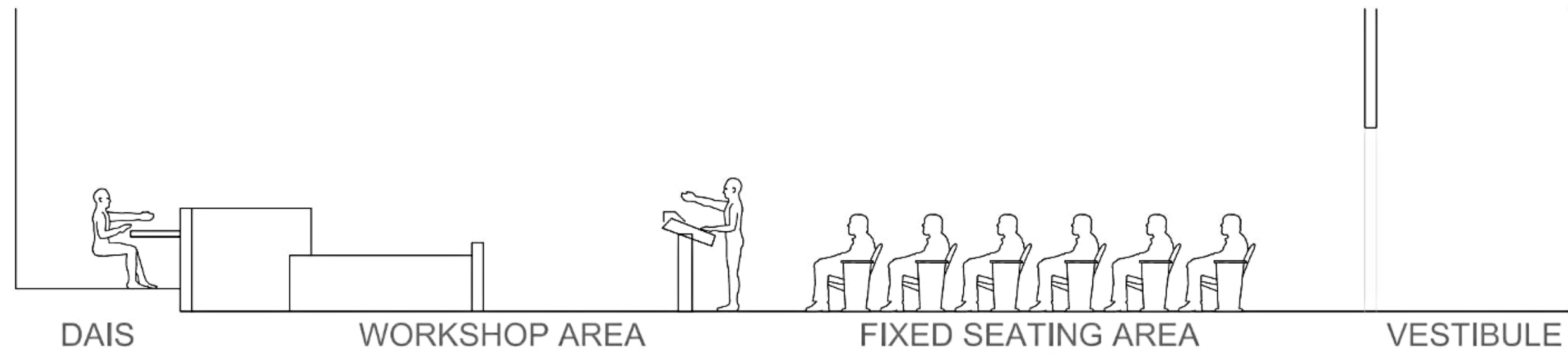

SECTION THROUGH COUNCIL CHAMBERS

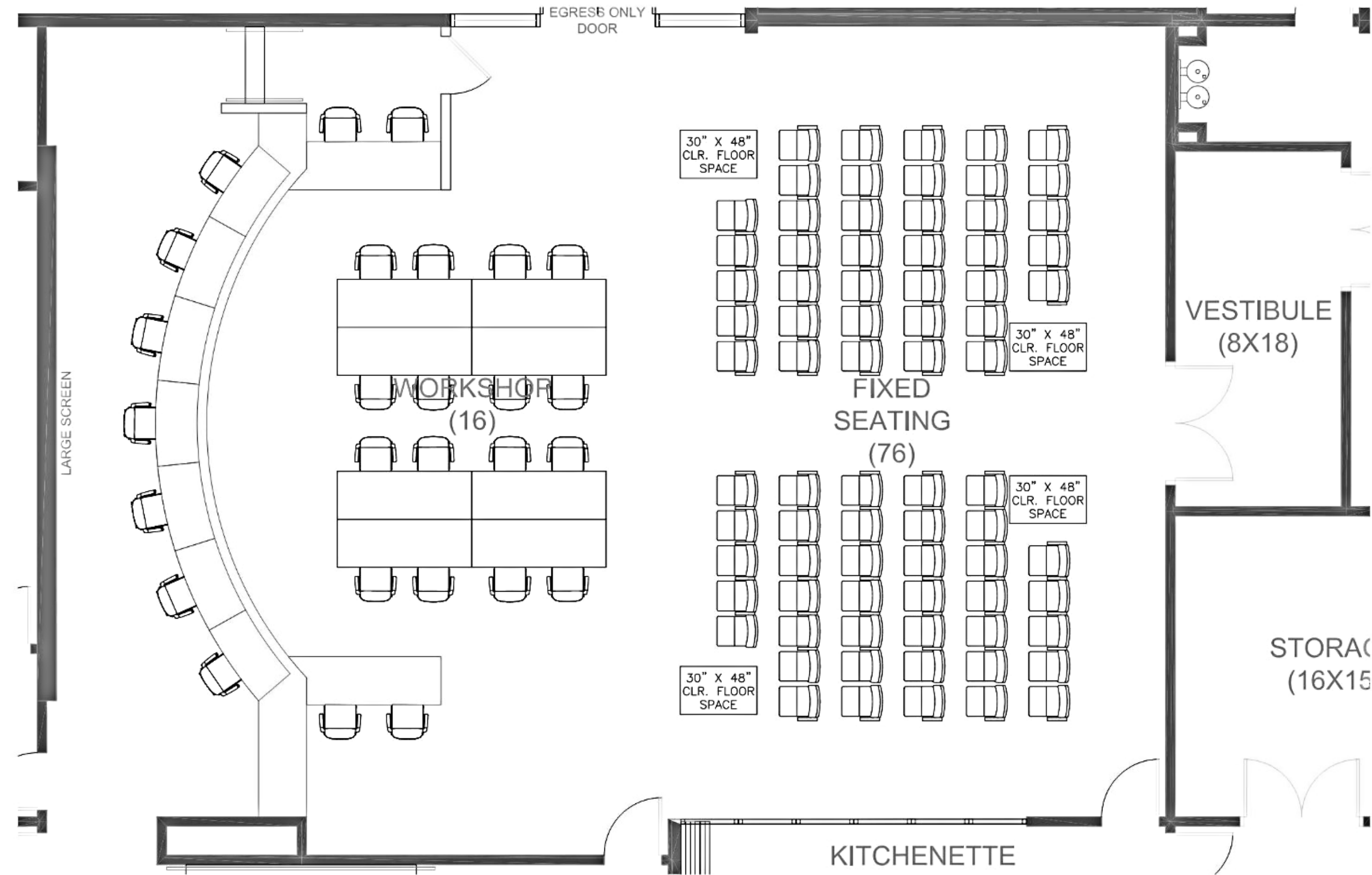

SAMPLE WORKSHOP LAYOUT

PHASE III (Community Center Renovation) : View Towards Dais



PHASE III (Community Center Renovation) : View From Dais



PROJECT SUMMARY

PROJECT SUMMARY : Total Cost Per Phase / Timeline



Phase – I
Construction

\$4,561,097
10 Months

City Hall	\$927,855
Community Center	\$1,178,073
Neighborhood Center	\$821,625
Senior Center	\$1,633,544
Total	\$4,561,097



Phase – II
Construction

\$2,802,299
10 Months

Furniture

\$390,000



Phase – III
Construction

\$4,064,056
8 Months

Furniture

\$110,000

AV

\$202,440

Escalation Projections

2025	5.00%
2026	6.00%
2027	5.00%
2028	4.00%



Thank You

